

 **SUNFLOWER TRIMMER®**  
TRIMMING IS EASY

# BUCKER - L



**USER MANUAL  
and  
WARRANTY FORM**



# USER MANUAL AND WARRANTY FORM

## BUCKER - L



1. Potential risks and safety warning	2
1.1 Protective equipment	2
1.2 Machine unpacking and installation	3
1.3 Other risks and recommendations	6
2. Machine basic description	7
2.1 General information	8
2.2 Range of use	8
2.3 Electrical connection	8
3. Operating and handling	
3.1 Connection to power source	9
3.2 Leveling and start up	9
3.3 Cylinder adjustment	11
3.4 Stem insertion	12
3.5 Changing of openings	13
4. Cleaning	17
5. Storage	17
6. Warranty	18

## POTENTIAL RISKS AND SAFETY WARNING

The trimmers from company Sunflower-trimmer Ltd. are designed and manufactured according to legal standards of EU focusing on maximum safety of the user during work with the machine. The user is obligated to read and understand the safety warning and recommended procedures specified in this manual.

**!** Please read this manual carefully before use of the machine.

### 1.1 PROTECTIVE EQUIPMENT



#### Safety goggles

Use plastic goggles with non-tinted visor and without UV filter. There is a risk of cut pieces of the flower can fly away and cause injury to your eyes.

## 1.2 MACHINE UNPACKING AND INSTALLATION

When unpacking the machine out of the box please follow the instruction below:

### 1. Unpacking the Bucker

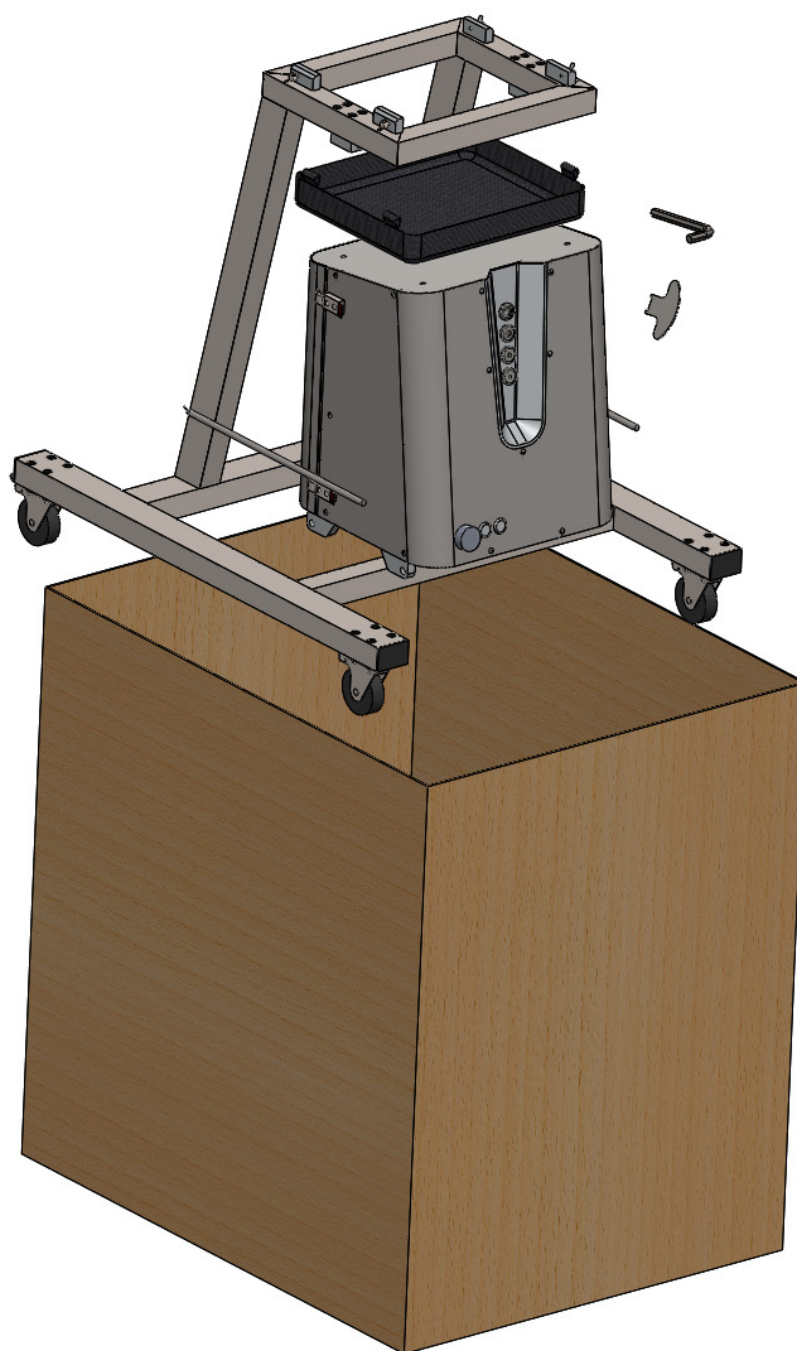

## 2. Installation of the machine on the table

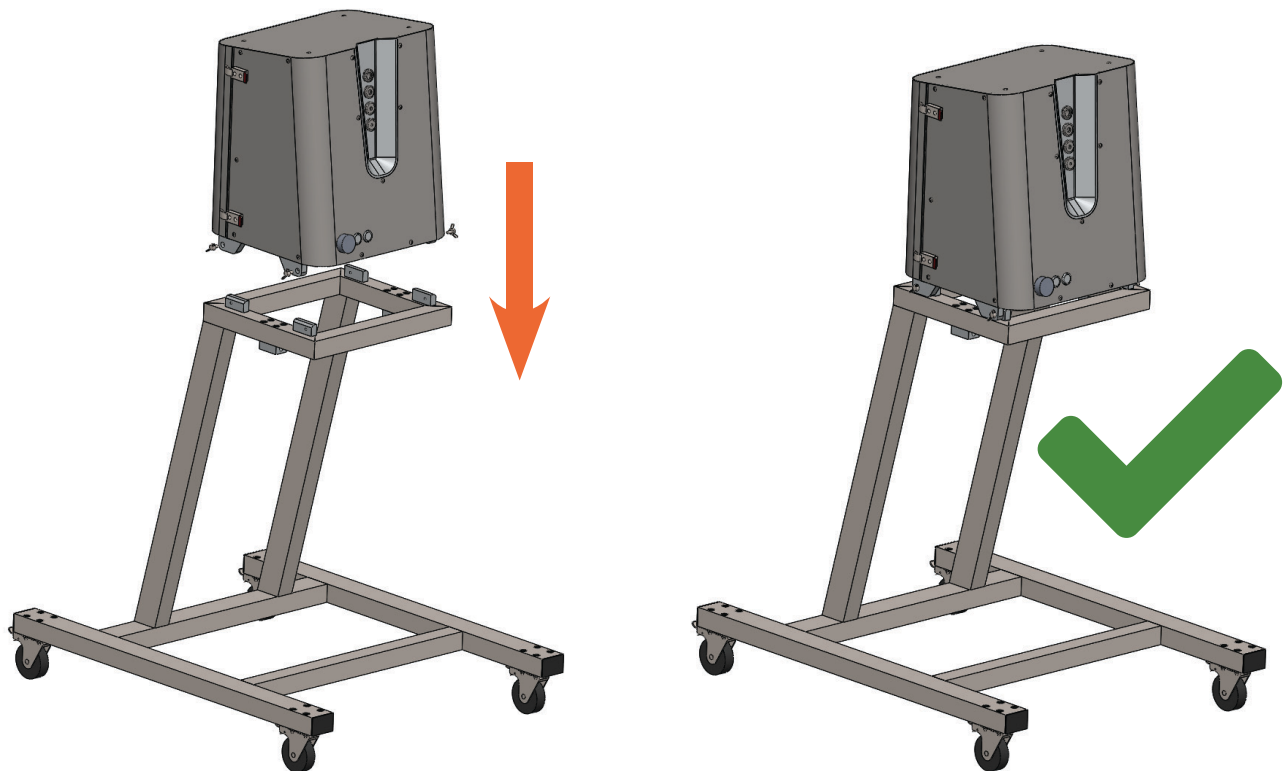

## 3. Fixation of Bucker stand to the table (wing nuts)

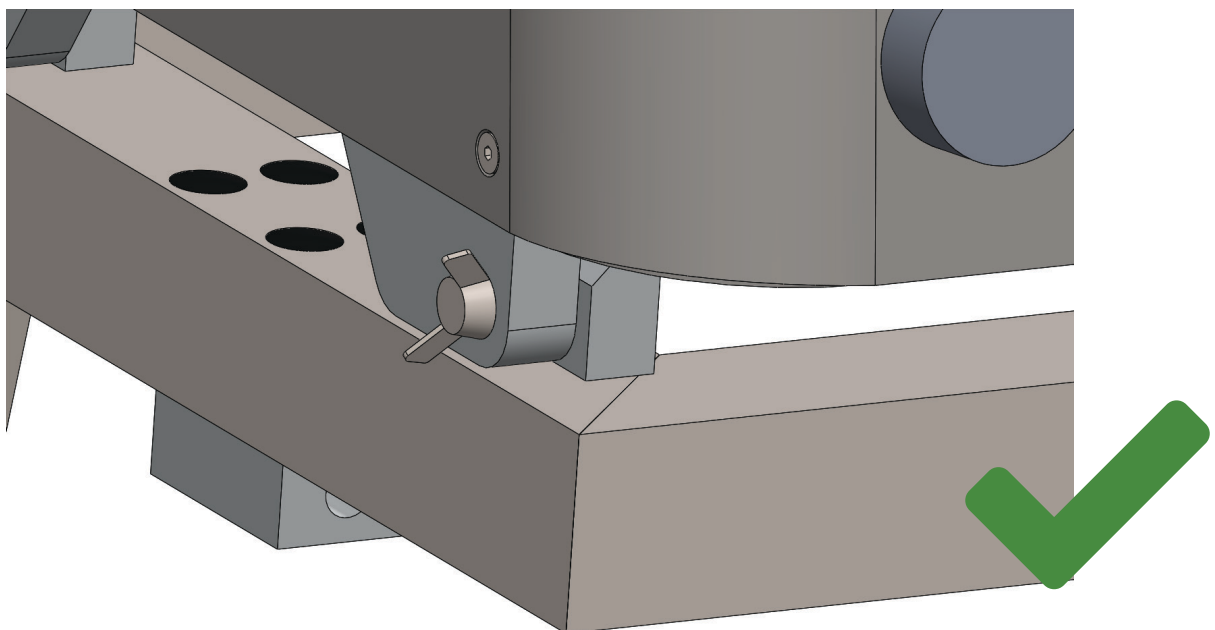

#### 4. Fixation of the bin

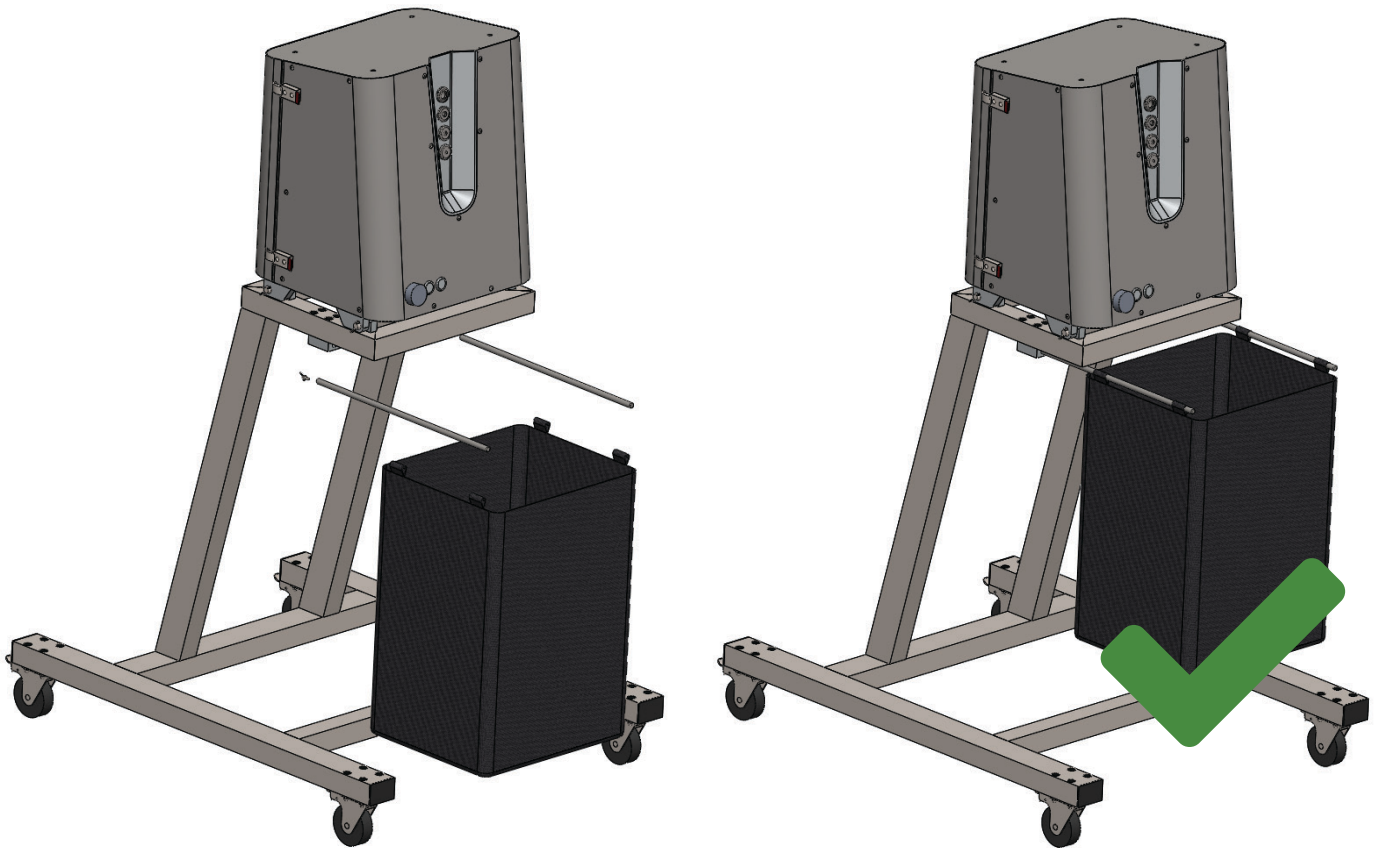

#### 5. Disassembly

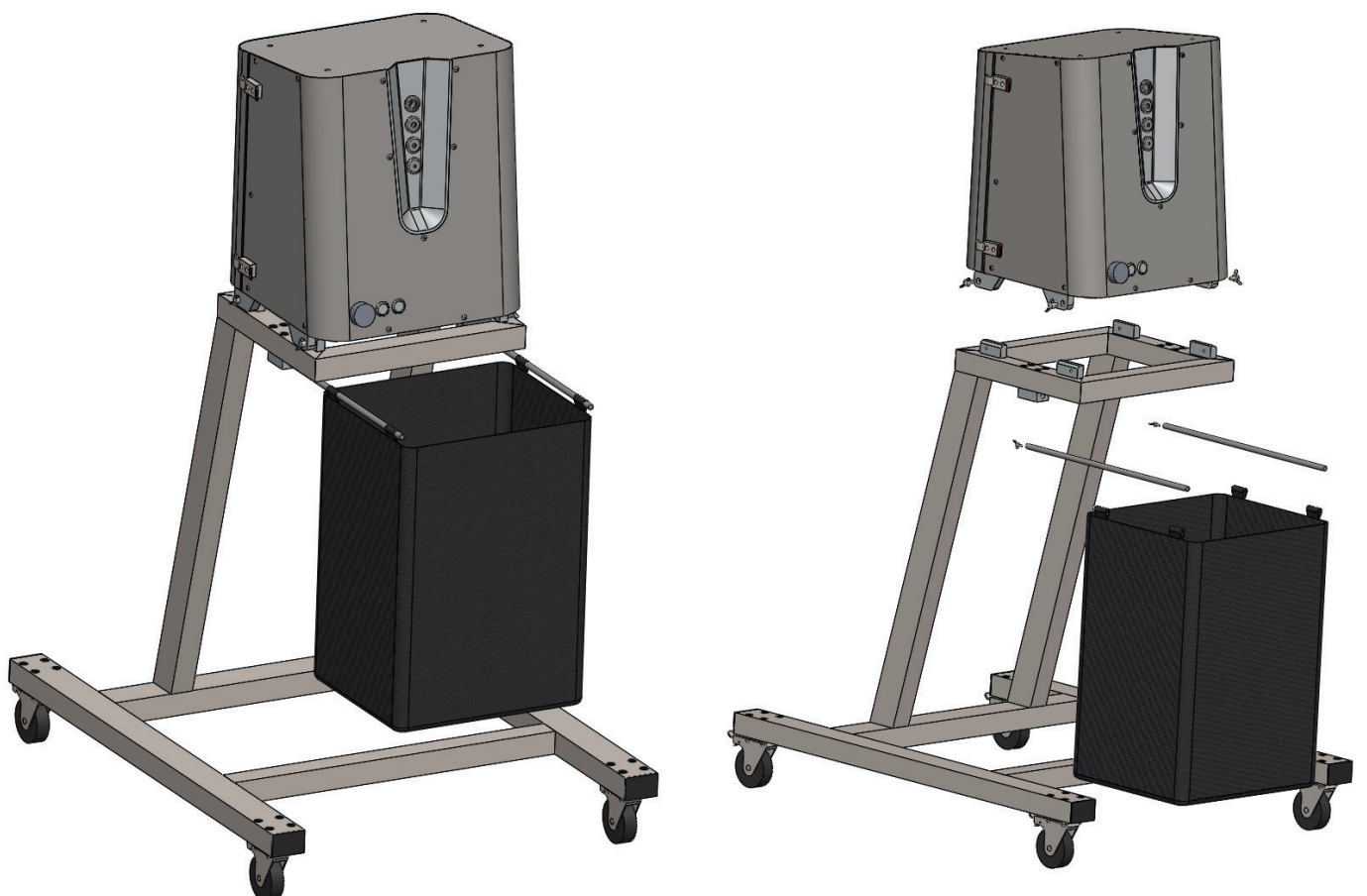



## 1.3 OTHER RISKS AND RECOMMENDATIONS

**Keep in mind your own safety at all times.**

**Do not use the machine in a dusty or wet environment.**

**!** Never open the back cover of the machine, when the motor and rotor is rotating.

**!** Never leave the machine in reach of children or persons under the age of 18 which are not familiar with the user manual.

- Clean the trimmer according to specifications under **chapter 4. Cleaning**. Following these instructions you can prevent the damage of the machine or harm to your own health.
- The machine can only be used for purposes specified in this manual, **chapter 2. Machine basic description- point 2.2 Range of use**.
- Never repair or exchange any part of the machine in case of malfunction.
- Keep the machine and it's storage space clean.
- The machine can be used in interior only. The use in exterior is not recommended.
- The machine is not water resistant!
- Pay attention to avoid damage of the electrical cables of the machine!
- Never reposition the machine when plugged to a power source!

## 2. MACHINE BASIC DESCRIPTION

**Device LB 01 is developed and built for you to speed up the separation of the stem from the flower.**

The main frame of the machine is made from an aluminum plate. This frame is the main supporting structure of the machine. The device cover is made from stainless steel and attached to the machine frame using screws. The Siemens motor rotates 2 rotors which draw in the stems of the plants. Mechanical gear ratio in gear-case is 1:5. Rotation speed range is adjustable by frequency converter and potentiometer. The rotors are made from material PolyTAN 44/80 and one cylinder is driven and the second cylinder is drifted.

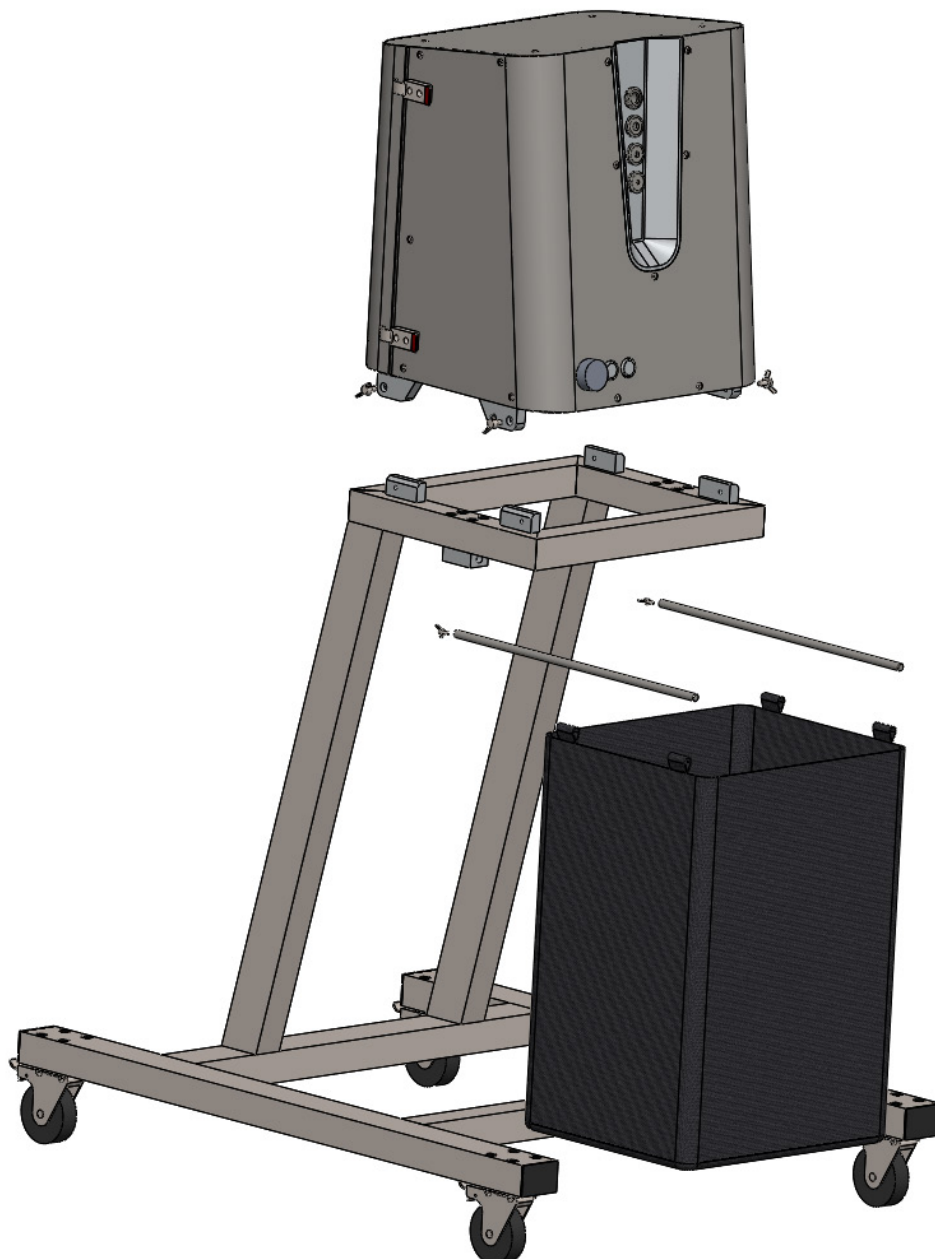



## 2.1 GENERAL INFORMATION

- The machine is turned on by a backlit button on the front side.
- The lightless button works as the rotation reverse.  
When holding the button the motor stops and the rotation changes.
- On the right side of the machine you can adjust the pressure of drifted cylinder.  
More about rotor setup in **chapter 3.3 Cylinder adjustment**
- Electrical wiring and electrical components is described in **section 2.3 Electrical wiring**

The purpose of Bucker L device is to remove the flowers from the stem.

The stem is inserted in the appropriate size orifice from the front side of the device.

The stem is pulled in and the flowers remain on the front plate of the device and drop into the collection bin or on the conveyor.

## 2.2 RANGE OF USE

- The machine can be used only for purposes specified by manufacturer.
- We strongly advise you to read all safety warnings before use of the trimmer!
- The machine is designed to separate the flowers from the stems of the plants.
- The machine can only be used on fresh plants with fleshy leaves and stalks which contains no ligneous and solid parts.  
This means you can cut the plants whose composition and solidity is similar to e.g. freshly harvested nettle.



## 2.3 ELECTRICAL CONNECTION

The machine contains electrical parts and connections. Electrical connection means cables and other parts connecting the electrical devices. The electrical parts are: motor with power consumption 370W, start up capacitor 20uF, 2 x power switch, potentiometer, 1x euro connector, 1x frequency converter and 1x interference filter.

**!** We particularly advise you to pay close attention to your safety during work and maintenance of your trimmer. You should not get in contact with electrical connection when using or cleaning the machine. Do not alter or reconnect the electrical connection!

## 3. OPERATION AND HANDLING

### 3.1 CONNECTING TO POWER SOURCE

Before you connect the trimmer to power source make sure you executed all safety precautions stated above.

**!** Before connecting make sure the back cover is firmly fastened.

#### Connecting the machine to a power source

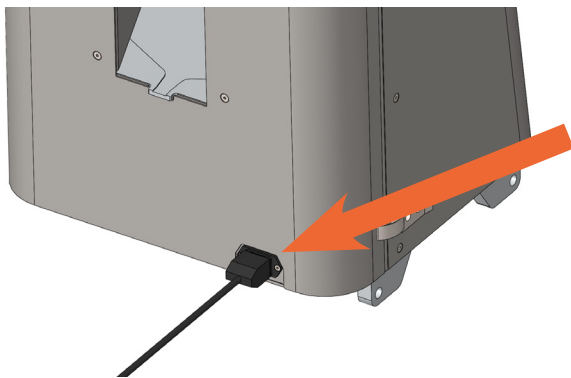

##### **Euro connector**

The connector for power input is on the back side. Connect the end of the power cable into it and the other end into the wall socket.

### 3.2 LEVELING AND START UP

#### Secure the wheels of the bottom frame.

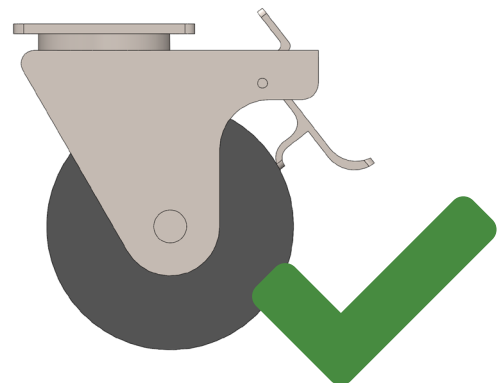
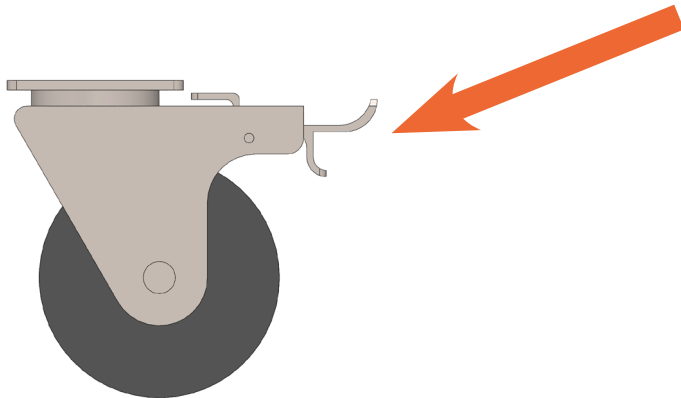

#### Make sure the back cover is closed.

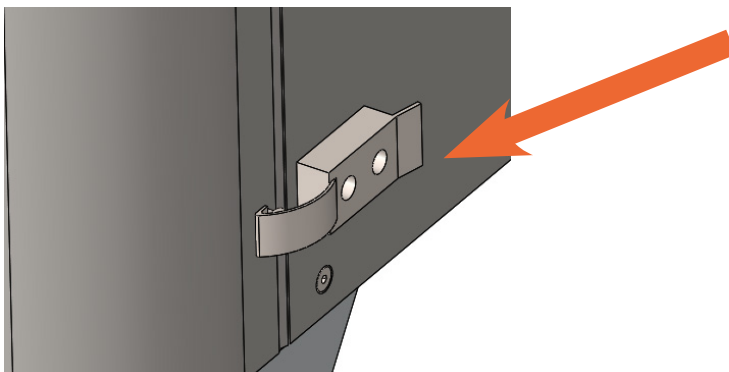

**The machine starts up by the right switch.**

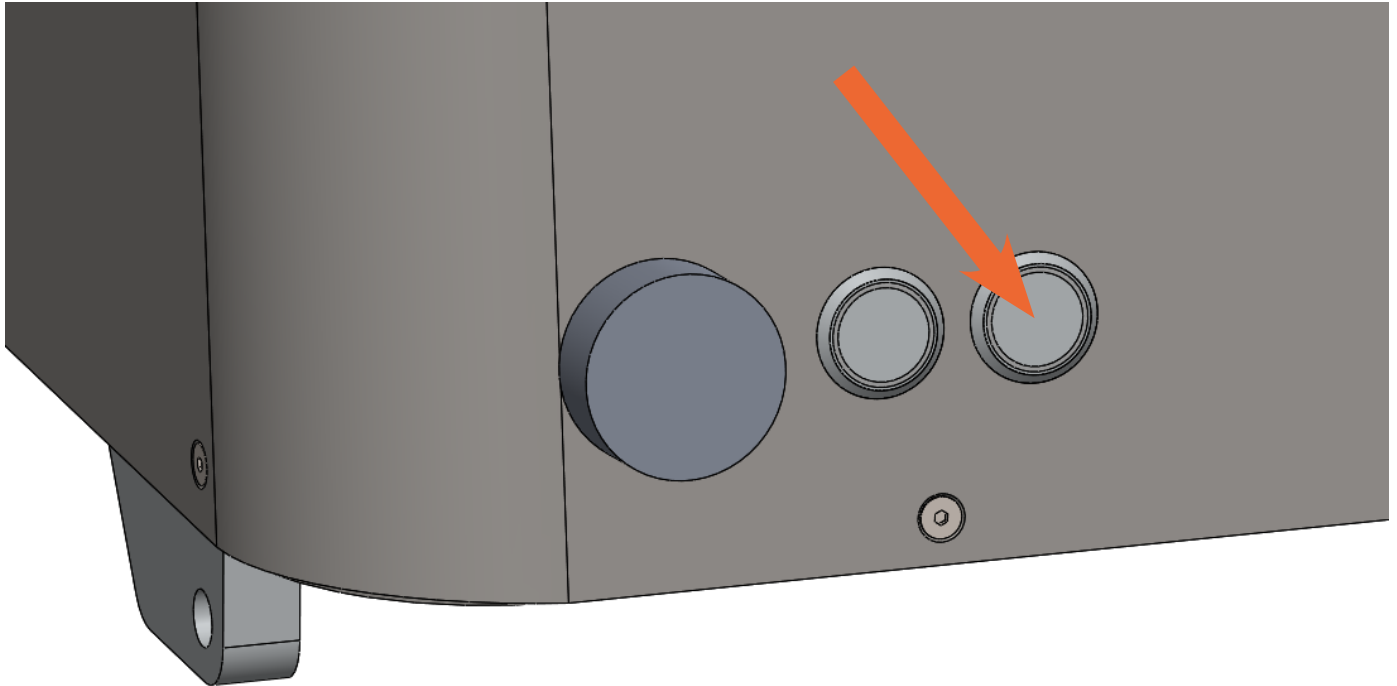

**i** Keep in mind all safety precautions stated above during power on of the trimmer!

**The left switch works as the rotation reverse.**

When holding the switch the motor stops and the rotors turn in the other direction.

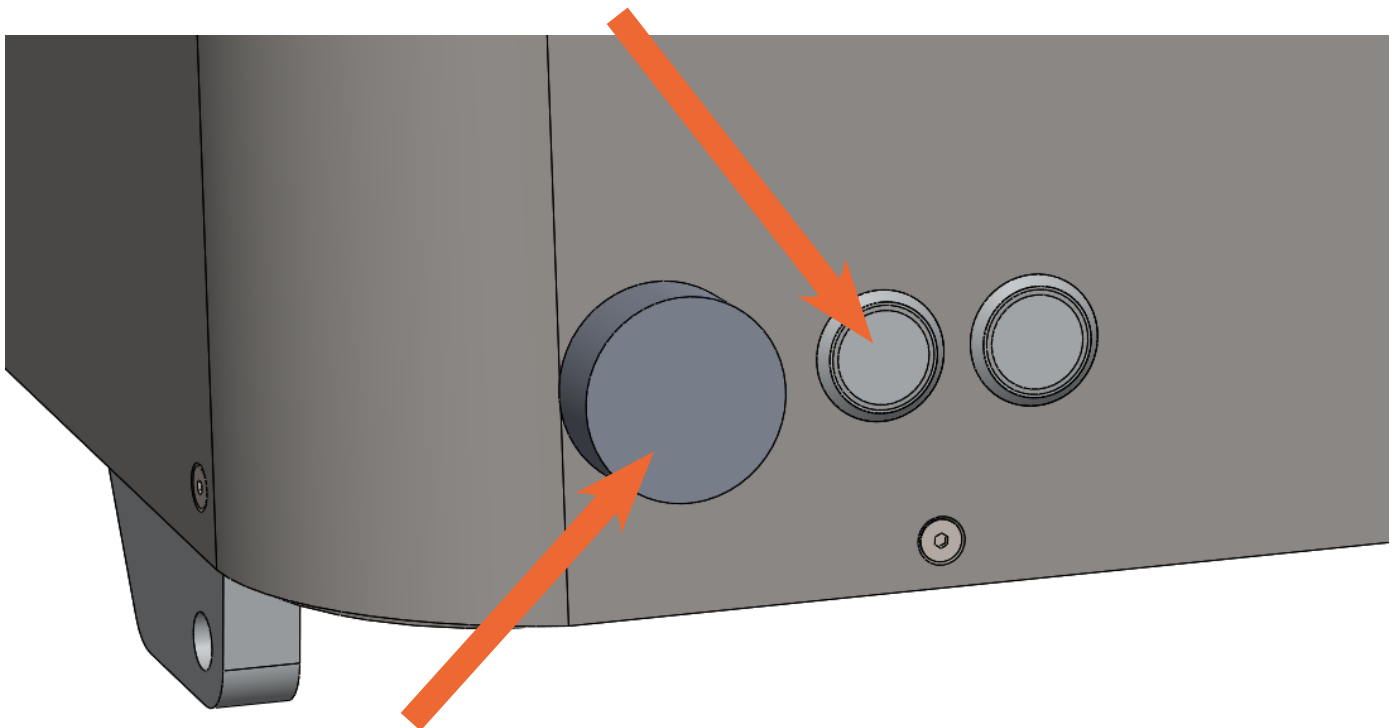

**The round switch is for changing the speed of the rotation of the motor.**

By turning it to the right you make the speed faster and by turning it to the left you make it slower.



## 3.3 CYLINDER ADJUSTMENT

**For the right functioning of the machine the cylinders have to touch.**

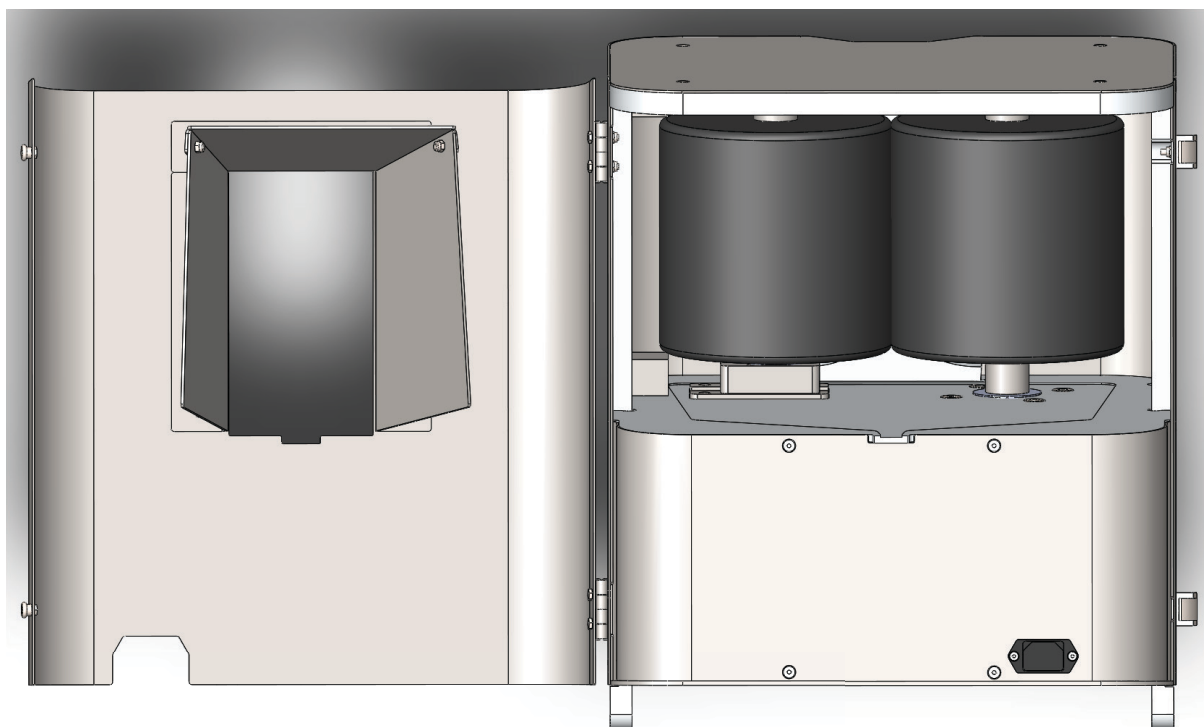

**Take the provided imbus key and by moving it to the right tighten the screw.**

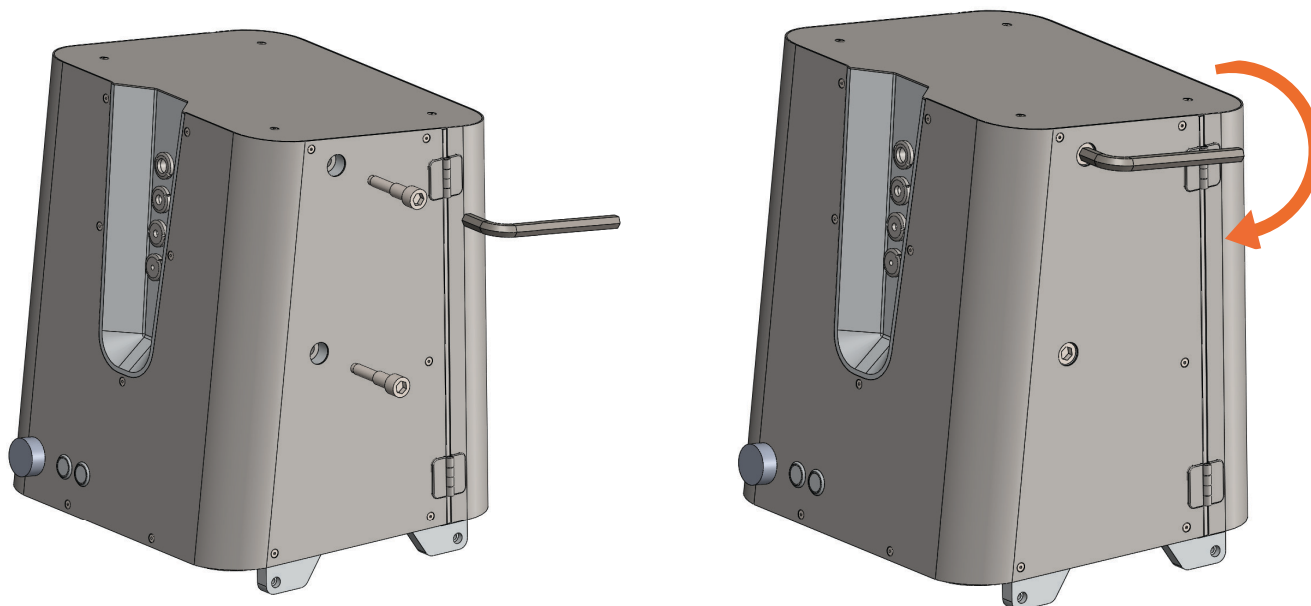

**!** Warning: If the cylinders don't rotate after turning the machine on, immediately disconnect the machine from the electrical socket and adjust the pressure of cylinders again.

## 3.4 STEM INSERTION

The stems are inserted into the machine through the openings on the front side.

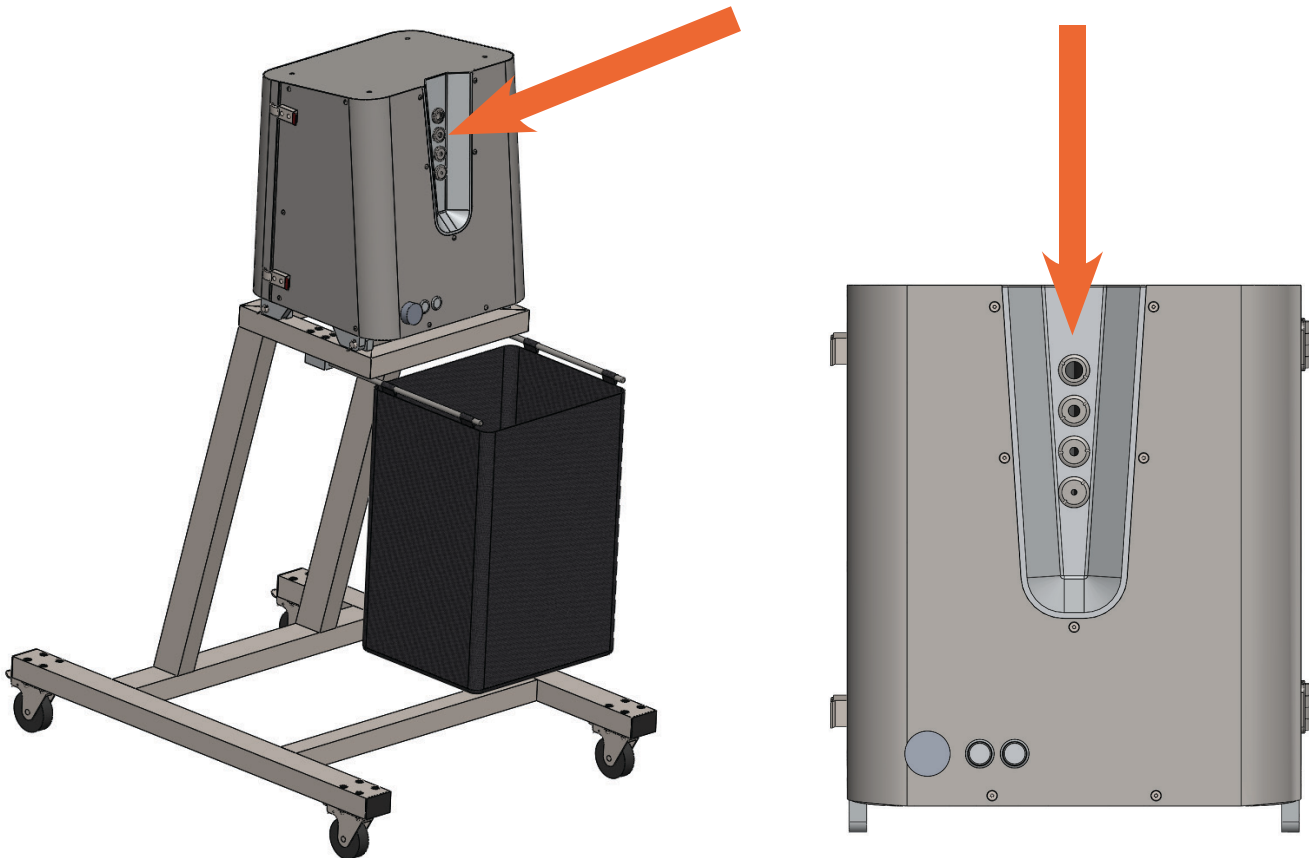

**i** Never insert any other material than described in **chapter 2.2.Range of use.** The machine could get damaged.

**i** In case something gets stuck between the cylinders use the rotation reverse.

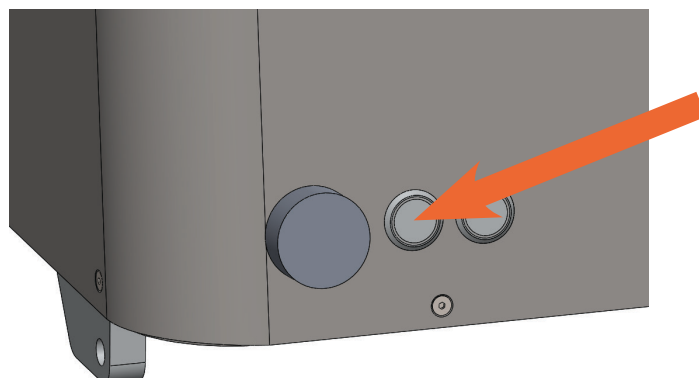

## 3.5 CHANGE OF ORIFICES

**Při výměně otvorů dbejte maximální opatrnosti a postupujte takto:**

**i** While changing orifices proceed with maximum caution and according to these instructions.

**1. Insert the key into the orifice and unscrew to the left.**

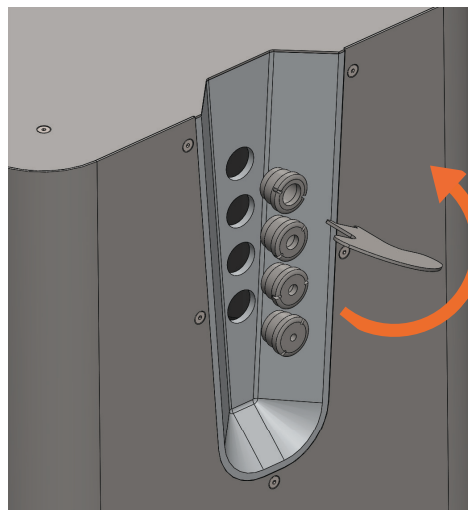
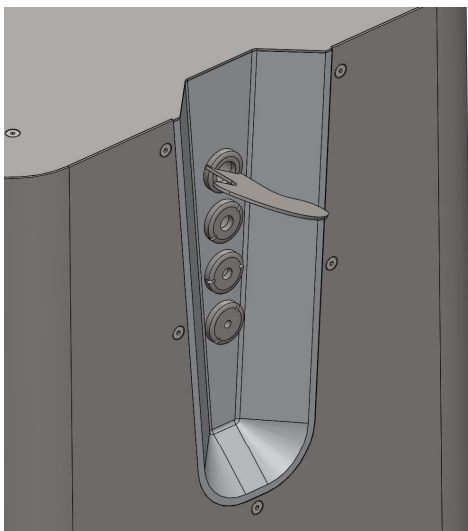

**2. Exchange the orifice for a new one and screw it to the right.**

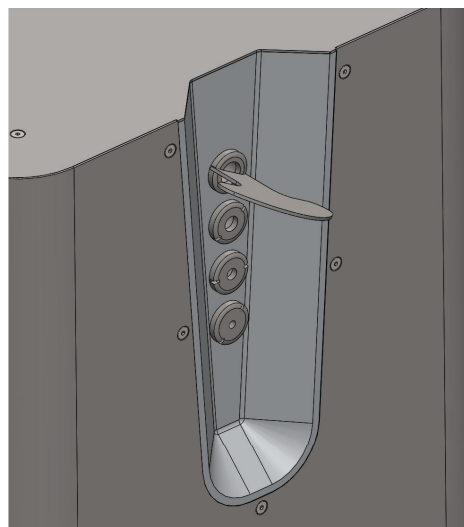
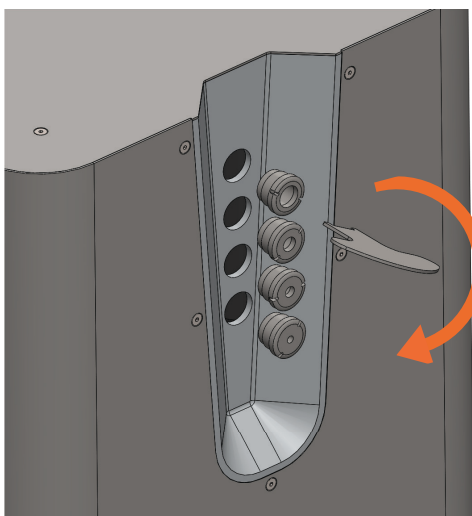



## 4. CLEANING

**After every trimming we recommend the following:**



- Clean all dirty spots of the machine using alcohol-based cleaner or other solvent.
- Make sure that no cut pieces of the plant get where they shouldn't
- Clean the walls of the cylinders.

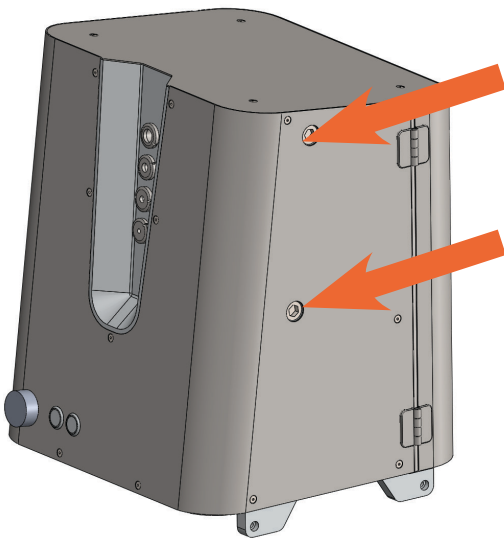

**i** For easier cleaning of the cylinders we recommend making them further apart using the adjustable screw.

## 5. STORAGE

**i** Store your machine in a clean and dry place.

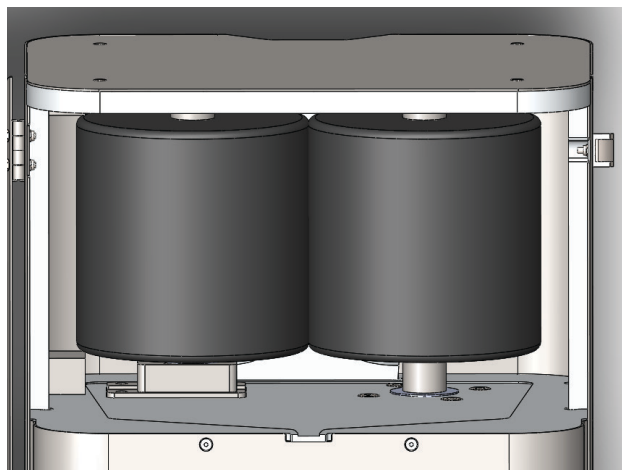

**Store your machine in a clean and dry place.**



## 6. WARRANTY FORM

**In order to acquire a 5 year warranty according to our warranty conditions available on [www.sunflower-trimmer.com](http://www.sunflower-trimmer.com) it's necessary to complete the following:**

- 1. Fill out and keep the warranty form.
- 2. Complete the warranty form with stamp of the seller and date of purchase.
- 3. Send a confirmation of purchase to: **info@sunflower-trimmer.com** latest within 30 days from the date of purchase. Include name of the retailer, date of purchase and serial number of the machine.
- You will receive a confirmation by email within one week.

Model of the machine

**BUCKER - L**

Serial number:

Stamp Sunflower-Trimmer, s.r.o.:

Stamp seller:

### **Sunflower-Trimmer, s.r.o.**

Kaprova 42/14

110 00 Praha

The Czech Republic

tel.: +420 602 418 139

e-mail: [info@sunflower-trimmer.com](mailto:info@sunflower-trimmer.com)

www: [info@sunflower-trimmer.com](http://info@sunflower-trimmer.com)

Made in the Czech Republic





[WWW.SUNFLOWER-TRIMMER.COM](http://WWW.SUNFLOWER-TRIMMER.COM)